

L:\NETMAN\HIGHWAYS\MAM1 - Delivery Team\Info\6. apt\Work\3. Projects\2021\ap\T063 - Plot 6 Hortonwood\04 Engineering\Drainage Strategy.dwg - 18/06/2021 14:20:23 - A1 Landscape - Vanessa.Roll

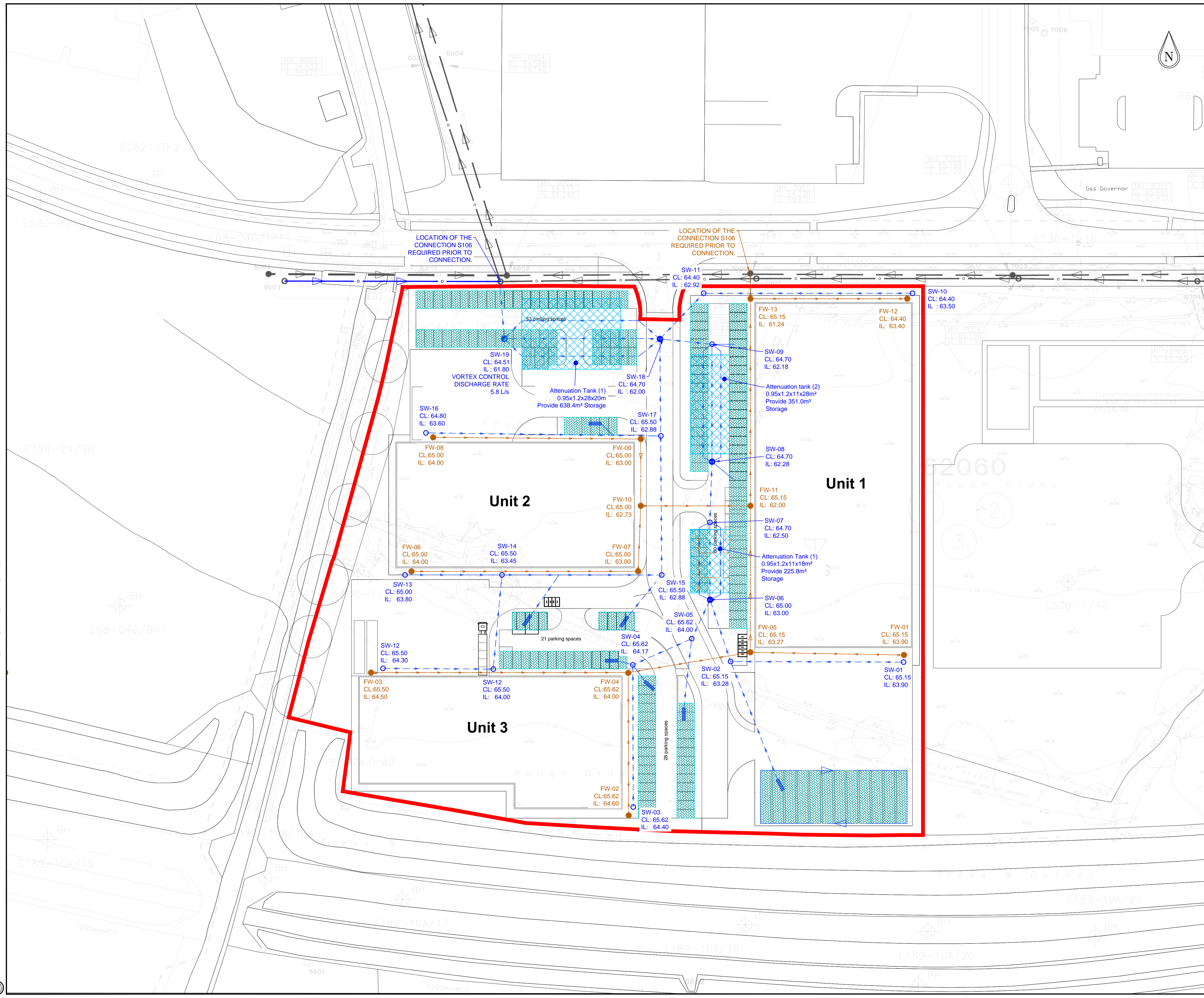

### Key

- Existing Private Surface Water Drain
- Existing Private Foul Water Drain
- Proposed Surface Water Drain Manhole.
- Proposed Foul Water Drain Manhole
- Site Boundary
- Permeable Block Paving/Asphalt  
0.95x1.2x2812xm² = 295m³  
PROVIDE STORAGE
- Attenuation Tank
- Proposed Silt Trap Manhole
- Proposed Flow Control Manhole
- Diffuser box

Rev	Rev. Date	Purpose of revision	Drawn	Checked	Rev'd	Appr'd
Client						
Project						
Plot 6 Hortonwood						
Drawing title						
Drainage Strategy						
Drawing status						
Preliminary						
Scale		1:500 @ A1	DO NOT SCALE			
Client: Omega Lighting & Electronics Ltd						
Drawing number						Rev
APT-053-01-DS-1001						00
This drawing is not to be used in whole or part other than for the intended purpose and project as defined on this drawing. Refer to the contract for full terms and conditions.						